

## Use cases Installation principles & wiring schemes

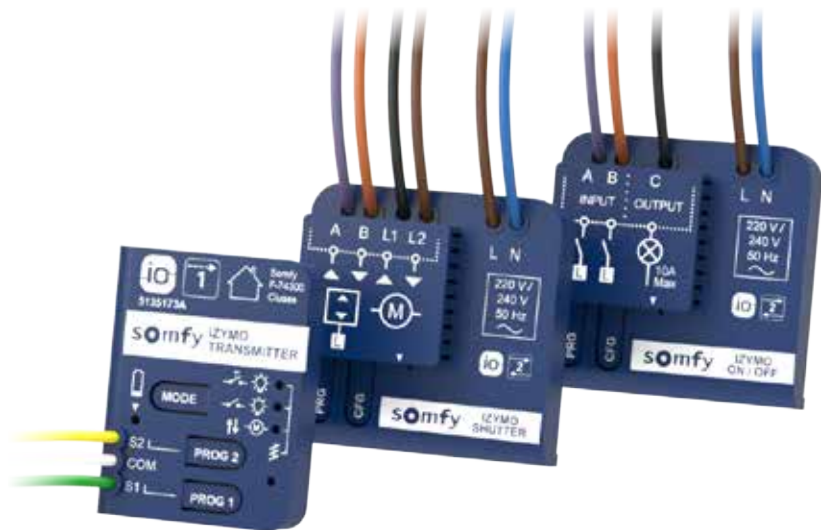



# Summary

## RANGE PRESENTATION

|   |   |
|---|---|
| Why we created this range .....         | 2 |
| Benefits for you & your customers ..... | 3 |
| IZYMO™ experiences .....                | 4 |

## LIGHTING

|   |    |
|---|----|
| Connect a single light.....                 | 12 |
| Connect a multiway switch.....              | 14 |
| Connect a latching relay installation ..... | 18 |
| Add an extra switch to a light .....        | 20 |

## ROLLER SHUTTER

|                         |    |
|-------------------------|----|
| Connect a shutter ..... | 24 |
|-------------------------|----|

# Why we created this range

The IZYM0™ io range is an accessible and seamless way to upgrade the already installed wired home equipment such as shutters, lighting, boiler... In that way, your customers will benefit from new features such as centralization, remote control (from remote to smartphone), presence simulation, scenario...



# Benefits

## FOR YOU

### **DESIGNED WITH PROFESSIONALS, FOR PROFESSIONALS**

#### **Radio performance**

Unique radio expertise thanks to the io protocol

#### **Range versatility**

3 references to answer most of the PROs' needs = less references to carry along for you

#### **Making installation easier for you**

- easy to integrate into the recessed box,
- several ways to pair the product,
- protection from wiring errors

The IZYMOTM range is fully compatible with TaHoma, **one of the most complete smart home solutions** on the market.

## FOR YOUR CUSTOMERS

### **UPGRADE YOUR HOME**

Simplify your daily home life in a snap... and relax!

**ACCESSIBLE:** The most economic way to upgrade your already installed wired home equipment: shutters, lighting, boiler... ; No need to change your installed switches

**SEAMLESS:** An installation that does not damage your interior: Fast and dust-free; Radio, so without wires; Keep using your installed switches; Preserve the design consistency of your switches

# IZYMO™ experience #1

## Centralised control for roller shutters

« Now, with my remote, **I can open and close all my wired shutters at once with just one click.** I no longer need to walk through the house checking them one by one. It's great, I save time and energy every morning and evening. »



# IZYMO™ experience #2

## Peace of mind when I go out

« With just one click on my smartphone, **I can make sure that all my shutters are closed and all my lights are off** when I go out. I no longer need to spend time checking every room... So that's one less thing to worry about every morning! »



# IZYMO™ experience #3

I can make it look like I'm at home when I'm out

« Thanks to TaHoma, I can make my house come to life whenever I want by launching the “presence simulation” scenario. The shutters open and close, and the entrance lighting goes on and off. **This makes it look like I'm at home**, even if I'm actually at work or on holiday - giving me complete peace of mind. »





# IZYMO™ experience #4

## Lights, camera, action!

« Using Amazon's vocal assistant, I can change the look and feel of my living room in the blink of an eye. "Alexa, turn on movie night"... In seconds, the shutters go down, the main light switches off and mood lighting comes on - **creating the perfect ambience for watching a movie!** »



# IZYMO™ experience #5

## An extra switch wherever you need it

« My electrician has added an extra light switch near my headboard, without running any extra cable or damaging my wall. Now I can switch my main bedroom light on and off without getting out of bed and trying to find my way back in the dark. That makes life easier and safer. »



# IZYMO™ experience #6

## Check your smart home equipment from anywhere

« Sometimes when I'm out, I can't remember whether I closed all the shutters or switched off all the lights at home. Now, no matter where I am, I can simply check on my smartphone. And if I did forget anything, all it takes is one click to sort it out. »



# IZYMO™ experience #7

## Added security with one click

« As my shutters can be controlled remotely, I can simply close them using my smartphone whenever I have to dash out or get stuck working late. This helps keep my home safer and warmer and gives me peace of mind. »

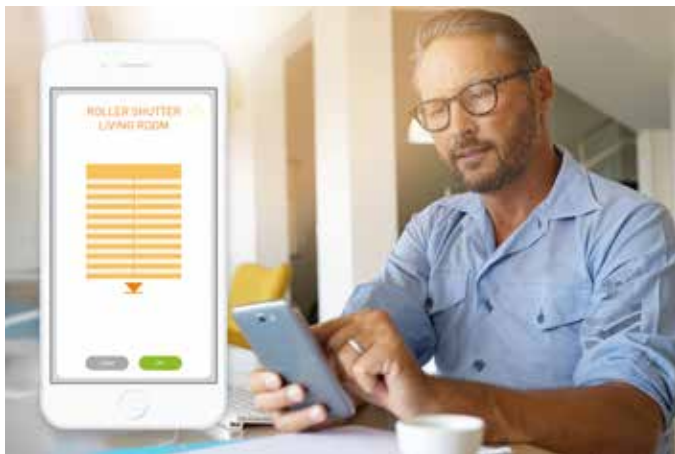

# LIGHTING

Installation principles & wiring schemes



# Connect a single light

**The neutral is available  
behind the switch**

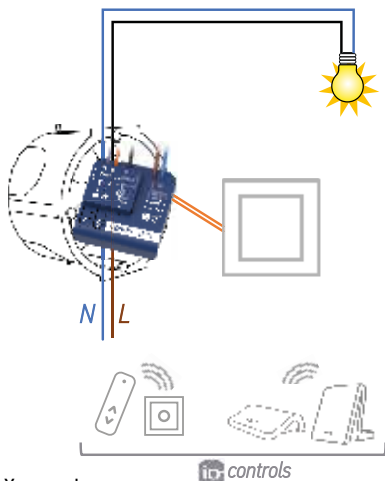

**You need:**

1 x IZYMO ON-OFF receiver io :  
1822649/1822650

**The neutral is not available  
behind the switch**

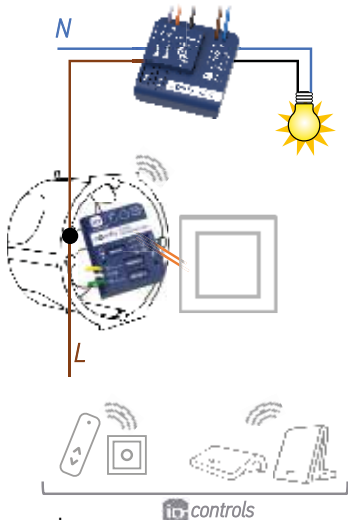

**You need:**

1 x IZYMO ON-OFF receiver io :  
1822649/1822650  
1 x IZYMO transmitter io :  
1822609/1822628

# Wiring scheme

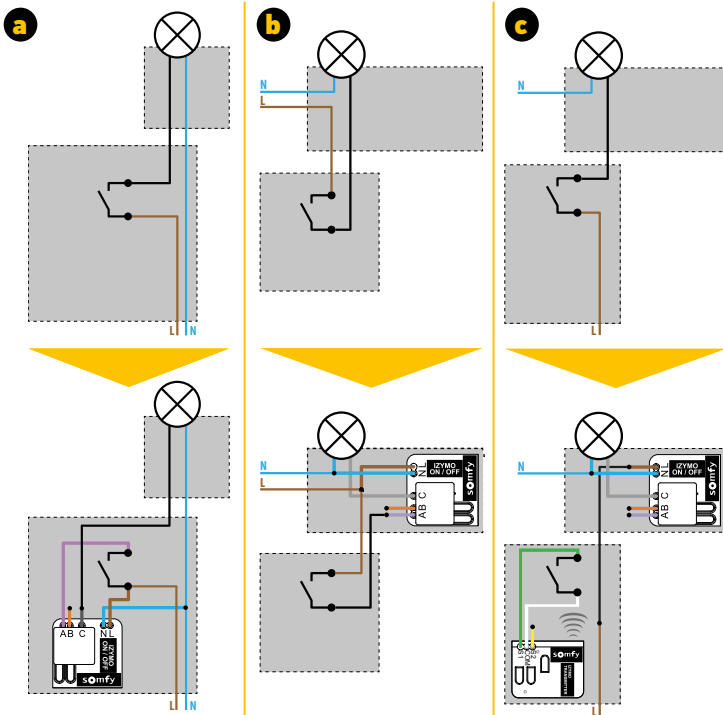

# Connect a multiway switch

**The neutral is available  
behind the switch**

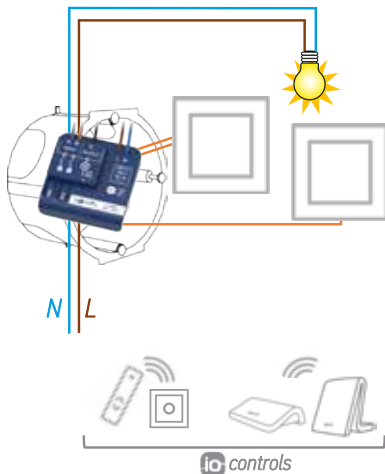

**You need:**

1 x IZIMO ON-OFF receivers io :  
1822649/1822650

**The neutral is not available  
behind the switch**

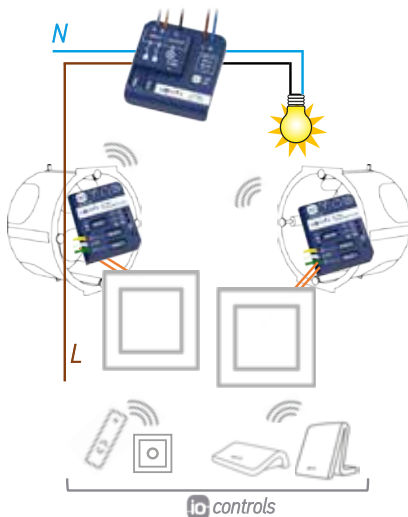

**You need:**

1 x IZIMO ON-OFF receiver io :  
1822649/1822650  
2 x IZIMO transmitters io :  
1822609/1822628



# Wiring scheme

without neutral behind the switch

**a**

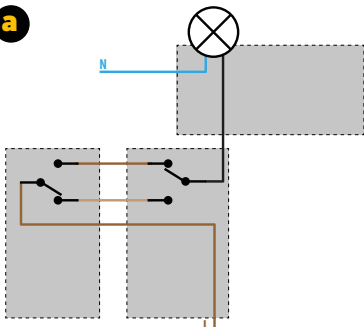

**b**

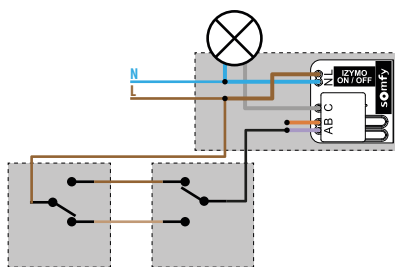
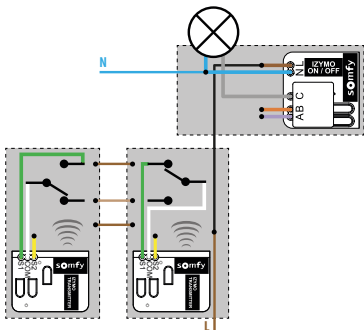
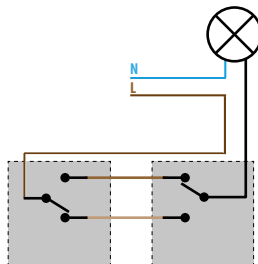

# Wiring scheme

with neutral behind the switch

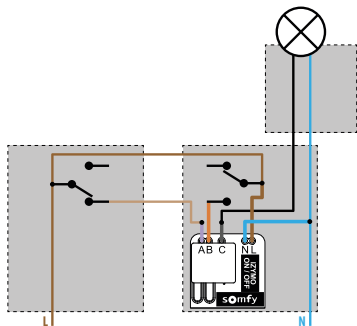
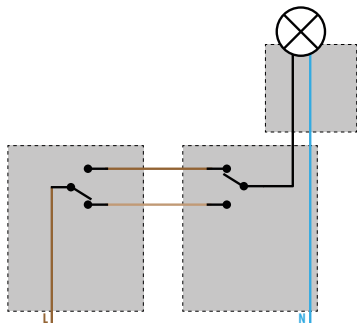



# Connect a latching relay installation

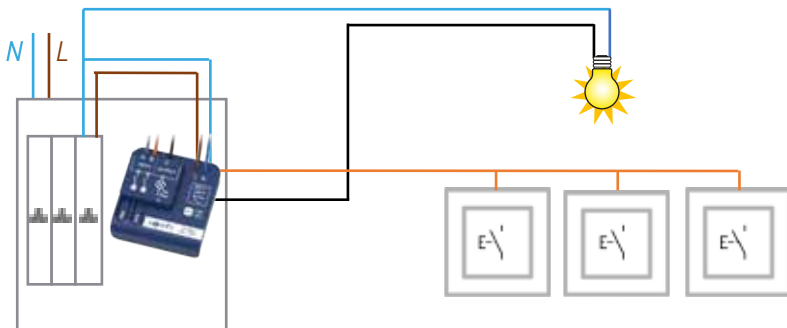

## You need:

1 x IZYM ON-OFF receiver io :  
1822649/1822650



**The latching relay in the electrical cabinet must be removed**

# Wiring scheme

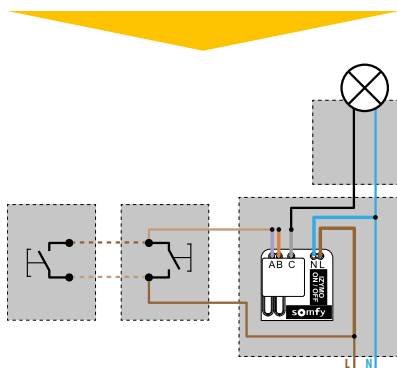
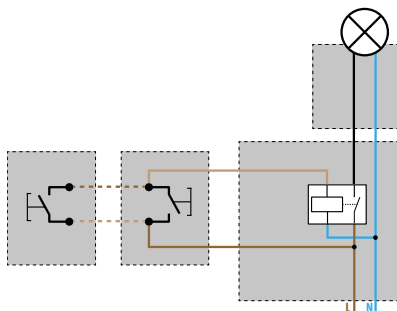

# Add an extra switch to a light

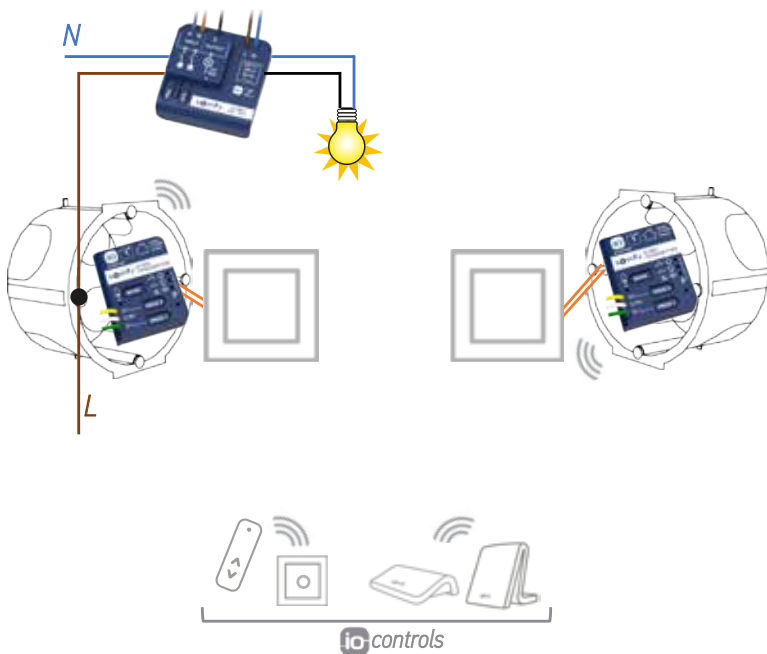

## You need:

1 x IZYO ON-OFF receiver io : 1822649/1822650

2 x IZYO transmitters io : 1822609/1822628

# Wiring scheme

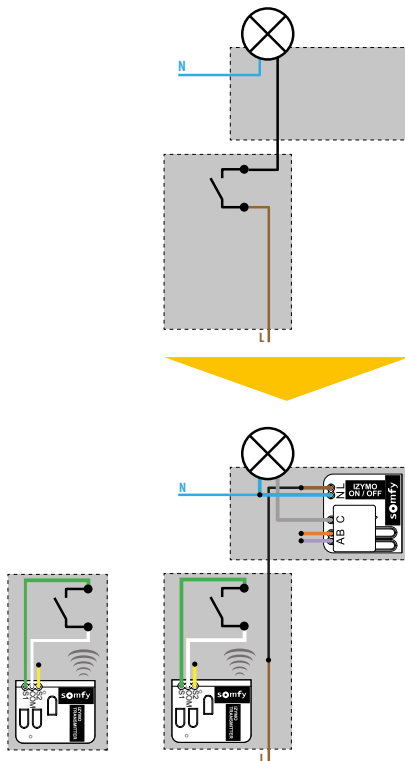





# ROLLER SHUTTER

Installation principles & wiring schemes

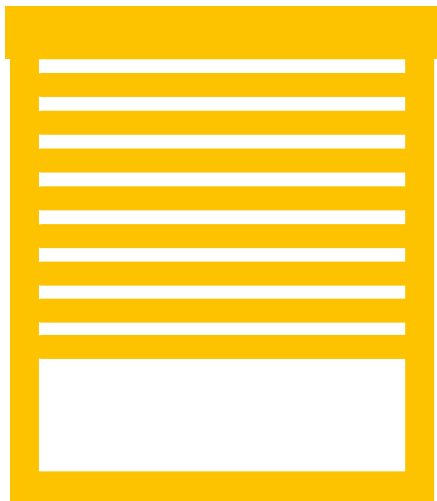

# Connect a shutter

**The module can be installed behind the switch...**

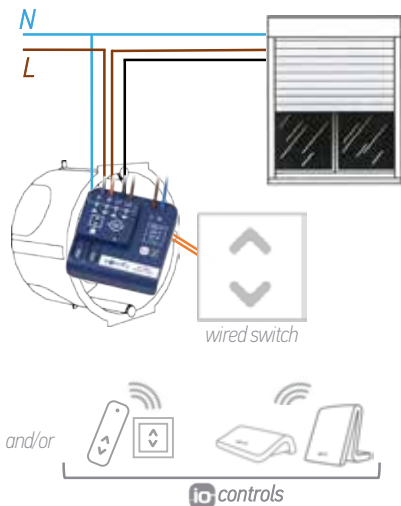

**Or near the wired motor**

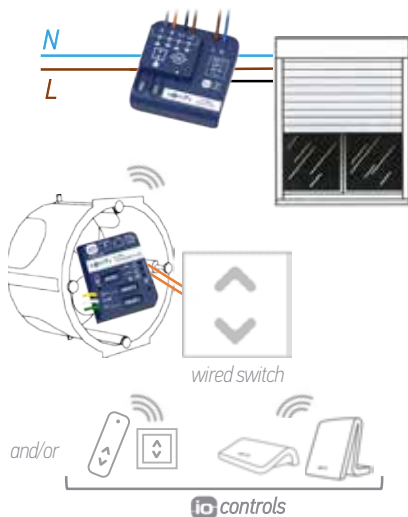

**You need:**

1 x IZYMO shutter receiver io :  
1822660/1822661

**You need:**

1 x IZYMO shutter receiver io :  
1822649/1822650  
1 x IZYMO transmitter io :  
1822609/1822628

# Wiring scheme

The module can be installed  
behind the switch...

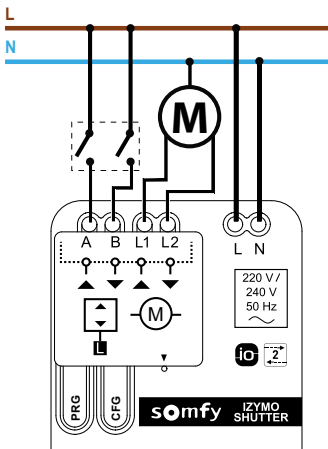

Or near the wired motor

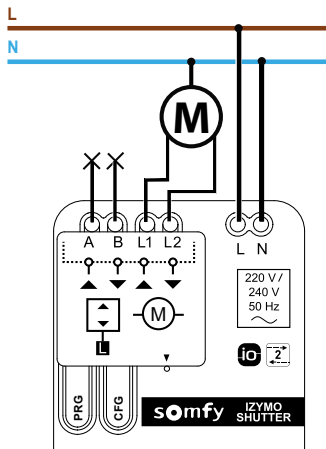

---

Installation  
tutorials  
available on



**SOMFY ACTIVITES SA**

50, avenue du Nouveau Monde

F-74300 CLUSES

[www.somfy.com](http://www.somfy.com)

*Copyright © 2018 SOMFY ACTIVITES SA, Société Anonyme. All rights reserved.*

*Capital 35.000.000 Euros, RCS Annecy, 303.970.230 - 01/2019.*

*Images are not contractually binding.*